

Thank you for choosing The Tray by **RockBoard®**!

The **RockBoard®** The Tray is a universal power supply mounting solution for almost every multi-power supply. Thanks to the practical one-size-fits-all design, The Tray can be mounted under all new **RockBoard®** pedalboards (with the exception of the DUO series). No drilling is required to attach The Tray and it can be attached to the board with just a single rivet.



Mounting

Step 1

Take the **RockBoard®** The Tray and mount your power supply on it. We recommend the use of hook & loop tape or cable ties.



Step 2

Place the lugs of the **RockBoard®** The Tray into the designated cutouts in the support braces of your **RockBoard®**.



Step 3

Place the **RockBoard®** The Tray so that the mounting holes of the **RockBoard®** The Tray and the **RockBoard®** pedalboard overlap.



Step 4

Take one of the included plastic rivets and separate the upper and the lower parts.



Step 5

Push the lower part of the rivet into the lined up mounting holes. For optimal fixation the bottom part must be placed flat to the surface of the **RockBoard®** The Tray.



Step 6

Push in the upper part of the rivet until latches into the bottom part. The Tray is now completely mounted. To remove The Tray, loosen the rivet by sliding a flat blade screwdriver into the recess on the side and carefully lift off the upper part of the plastic rivet.

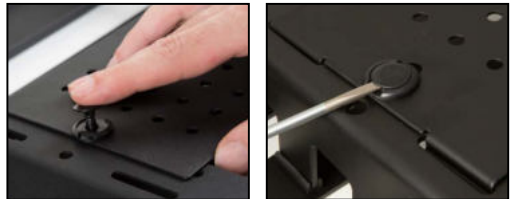

Note: The manufacturer reserves the right to change these specifications without notice.

USA DISTRIBUTION: Framus & Warwick Music USA, Inc. | info@rockboard.net | 629.202.6790

CHINESE DISTRIBUTION: Warwick Music Equipment Trading (Shanghai) Co. Ltd. | info@warwick.cn | +862134060110

NORTH EUROPEAN DISTRIBUTION: www.rockboard.de | info@rockboard.de | www.w-distribution.de | www.facebook.com/warwickmusicdistribution

Headquarters: Warwick GmbH & Co. Music Equipment KG | 08258 Markneukirchen / Germany | +49 (0) 37422 / 555 - 0

Family Owned • Solar Powered • Sustainably Manufactured in a Green Environment