

Red Panda™

RD-1 USER GUIDE

The RD-1 Pitch Delay is a digital delay with integrated pitch and frequency shifting, designed for immediate, hands-on control. Shift repeats once or endlessly in the feedback loop, from clean delays to subtly twisted textures and out-there sounds.

Small shifts create subtle evolution in repeats, while larger shifts produce chromatic or atonal cascades and pitch-shifted delays.

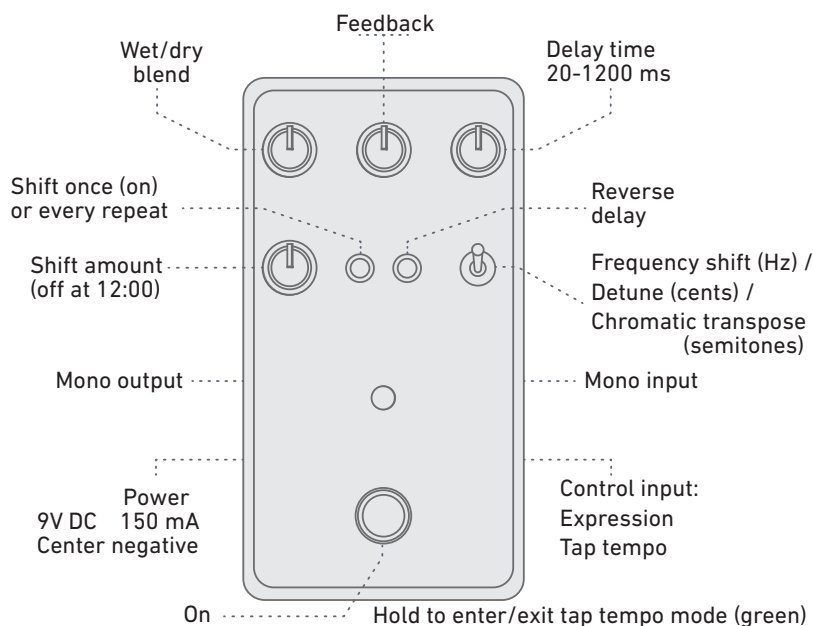

SAMPLE SETTINGS

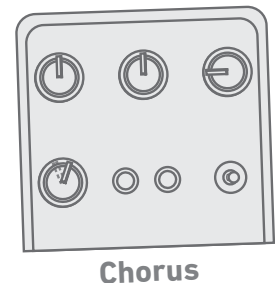
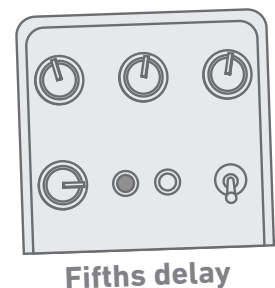
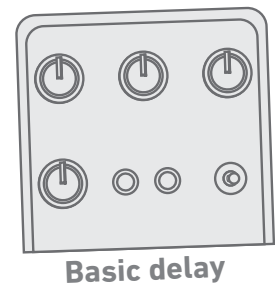

- Frequency shift for inharmonic effects and phasing
- Detune for micro pitch shifts (-400 to +300 cents)
- Chromatic transpose in semitone steps (± 12)
- Shift once for harmonized echoes and resonant feedback
- Reverse delay time is 2x the forward delay (40-2400 ms)
- Feedback extends beyond 100% with saturation
- Hold footswitch while plugging in control device:
 - Tap tempo: tap twice
 - Expression: heel down, then toe down
 - optional: set knobs and buttons at each position
 - Hold 2 seconds to save



Watch setup & demo videos
redpandalab.com/rd1